

# Build Your Own Cams

Cams can come in any shape or size, so there's no limit to how many kinds of motion you can create! Follow these steps to make your own cams for the automaton.

## Follow these steps:

- 1 Decide what shape your cam will be. Draw the shape on a piece of cardboard and cut it out.

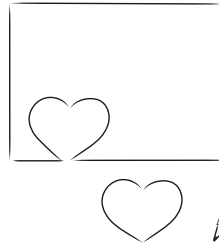

Or cut them out of the leftover cams from your kit!

- 2 Carefully poke a hole through the center of the cam. Then use scissors to widen the hole.

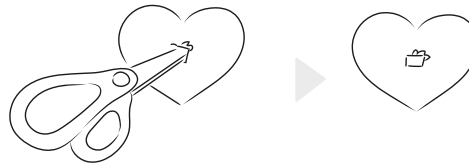

- 3 Slide the cam onto the crank to make sure it fits, then take the cam off. Pop out a sticky foam donut with a square hole and stick it to the cam.

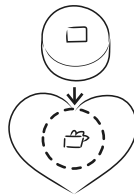

Use the scissors again if the crank doesn't fit.

- 4 Put the cam back on the crank. Add a spinner or slider and a character, then spin the crank. What did the motion look like?

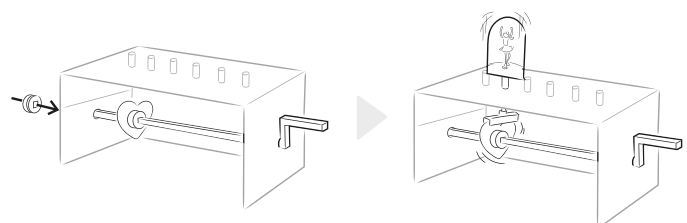

## Now, experiment!

Make more cams and compare their motions.

You can make a hole in the center of the cam or have an offset hole.

↳ not in the center

Try shapes like a:  
teardrop    oval  
star        square  
semicircle

